

Standard Poly 1.5 & 2 Inch Pumps

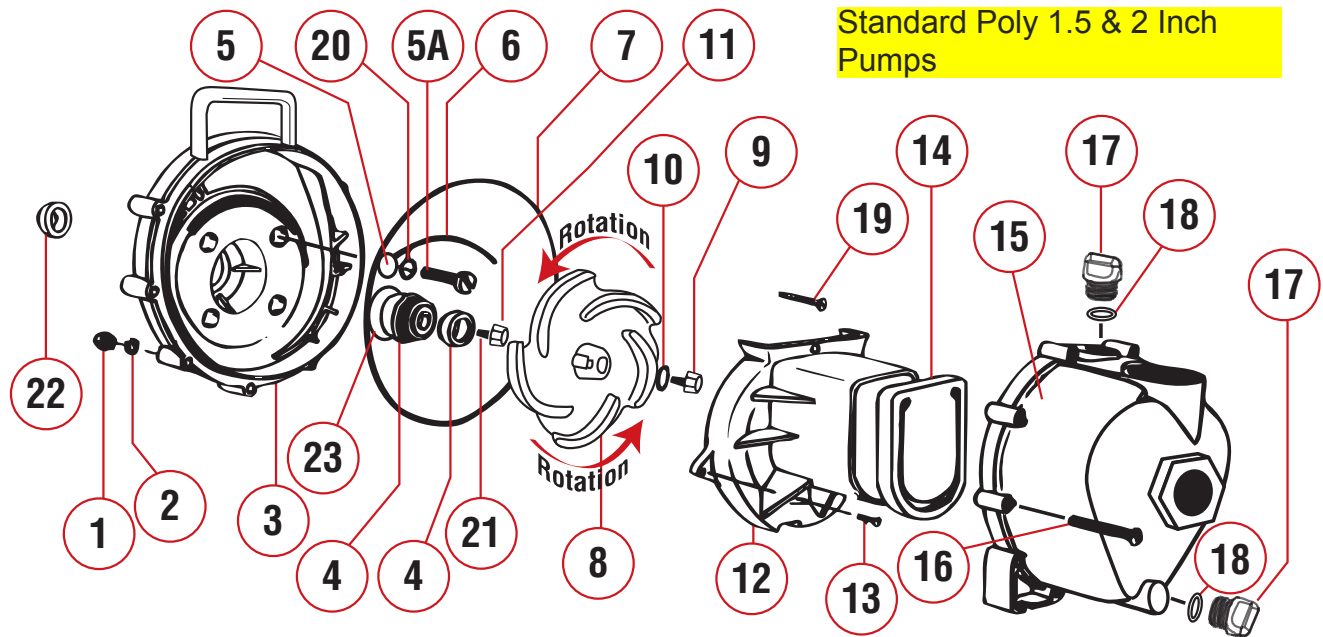

REPLACEMENT PARTS 1½" POLY PUMPS			
ITEM	PART NO	DESCRIPTION	QTY
1	V07019	SS Body Nuts	10
2	V07018	SS Lock Washers	10
3	12703A	Poly Pump Rear Bracket	1
4	12713	Seal Assembly	1
4	12713V	FKM (viton type) Seal Assembly w/316 SS Cup & Spring	1
5	12717	O-Ring for Screw Head	4
5	12717V	FKM (viton type) O-Ring for Screw Head	2
5A	12715A	SS Bracket Screws	4
6	12754	O-Ring Segment	1
6	12754V	FKM (viton type) O-Ring Segment	1
7	12719A	Body O-Ring	1
7	12719AV	FKM (viton type) Body O-Ring	8
8	12771A	3 Vane Impeller	1
9	12765A	SS Impeller Bolt	1
10	12774VA	Impeller Bolt Gasket	1
11	12775A	Impeller Hex Nut	1
12	12702A	Poly Pump Volute	1
13	12725	SS Volute Screws	2
14	12705	Poly Pump Check Valve	1
14	12705V	FKM (viton type) Pump Check Valve	1
15	12711A	Body Assembly	1
16	12720	SS Body Screws	10
17	12777	Prime/Drain Plug	2
18	UV15163	Prime/Drain Plug O-Ring	2
18	UV15163V	FKM (viton type) Prime/Drain Plug O-Ring	1
19	12900	SS Upper Volute Screw	4
20	12901	SS Rear Bracket Washer	1
21	12902A	Impeller Key	1
22	12716	Poly Pump Slinger	1
23	12710	O-Ring for Seal Assembly	1
23	12710V	FKM (viton type) O-Ring for Seal Assembly	1
N/S	12882A	Bearing Pedestal	1
N/S	12099	7/16"-14 x 1.25" HHCS	1
N/S	12003A	3 Vane Impeller Repair Kit (Items 4-8, 10, 14, 18, 22, 23 & 12099)	1
N/S	12999A	Pump Seal/O-Ring Kit (Items 4-7, 10, 18, 22, 23 & 12099)	1
N/S	12999AV	FKM(viton type) Pump Seal/O-Ring Kit (Items 4-7, 10, 18, 22, 23 & 12099)	1

REPLACEMENT PARTS 2" POLY PUMPS			
ITEM	PART NO	DESCRIPTION	QTY
1	V07019	SS Body Nuts	10
2	V07018	SS Lock Washers	10
3	12703A	Poly Pump Rear Bracket	1
4	12713	Seal Assembly	1
4	12713V	FKM (viton type) Seal Assembly w/316 SS Cup & Spring	1
5	12717	O-Ring for Screw Head	4
5	12717V	FKM (viton type) O-Ring for Screw Head	2
5A	12715A	SS Bracket Screws	4
6	12754	O-Ring Segment	1
6	12754V	FKM (viton type) O-Ring Segment	1
7	12719A	Body O-Ring	1
7	12719AV	FKM (viton type) Body O-Ring	8
8	12772	5 Vane Impeller	1
9	12765A	SS Impeller Bolt	1
10	12774VA	Impeller Bolt Gasket	1
11	12775A	Impeller Hex Nut	1
12	12702A	Poly Pump Volute	1
13	12725	SS Volute Screws	2
14	12705	Poly Pump Check Valve	1
14	12705V	FKM (viton type) Pump Check Valve	1
15	12712A	Body Assembly	1
16	12720	SS Body Screws	10
17	12777	Prime/Drain Plug	2
18	UV15163	Prime/Drain Plug O-Ring	2
18	UV15163V	FKM (viton type) Prime/Drain Plug O-Ring	1
19	12900	SS Upper Volute Screw	4
20	12901	SS Rear Bracket Washer	1
21	12902A	Impeller Key	1
22	12716	Poly Pump Slinger	1
23	12710	O-Ring for Seal Assembly	1
23	12710V	FKM (viton type) O-Ring for Seal Assembly	1
N/S	12882A	Bearing Pedestal	1
N/S	12099	7/16"-14 x 1.25" HHCS	1
N/S	12000A	5 Vane Impeller Repair Kit (Items 4-8, 10, 14, 18, 22, 23 & 12099)	1
N/S	12000AV	FKM(viton type) Impeller Repair Kit (Items 4-8, 10, 14, 18, 22, 23 & 12099)	1
N/S	12999A	Pump Seal/O-Ring Kit (Items 4-7, 10, 18, 22, 23 & 12099)	1
N/S	12999AV	FKM(viton type) Pump Seal/O-Ring Kit (Items 4-7, 10, 18, 22, 23 & 12099)	1